

**MODELS:
RRS-C2XX
RRS-C23H
RRS-B2XX
RRS-B23H**

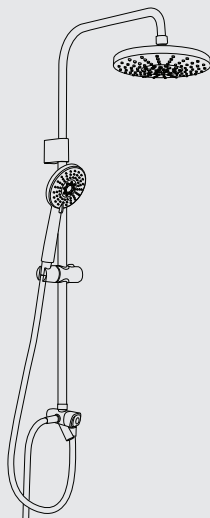

Rainshower accessories

Instructions for use, installation, and connection

Rinnai

PART CONTENT CHECKLIST

MODEL: Rainshower accessories

1 x Rain Shower Head

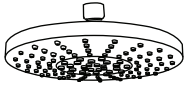

1 x 3-Way Diverter Valve with Tap

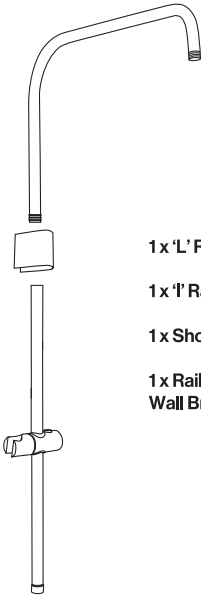
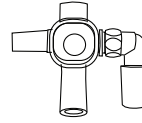

1 x 'L' Rainshower Sliding Rail

1 x 'I' Rainshower Sliding Rail

1 x Shower Holder

1 x Rail Support /
Wall Bracket

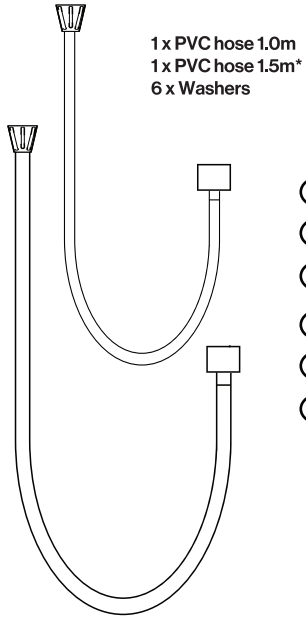

1 x PVC hose 1.0m
1 x PVC hose 1.5m*
6 x Washers

1 x Handshower Head*

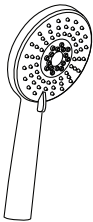

(*) For Singapore Model Only

(*) For Singapore Model Only

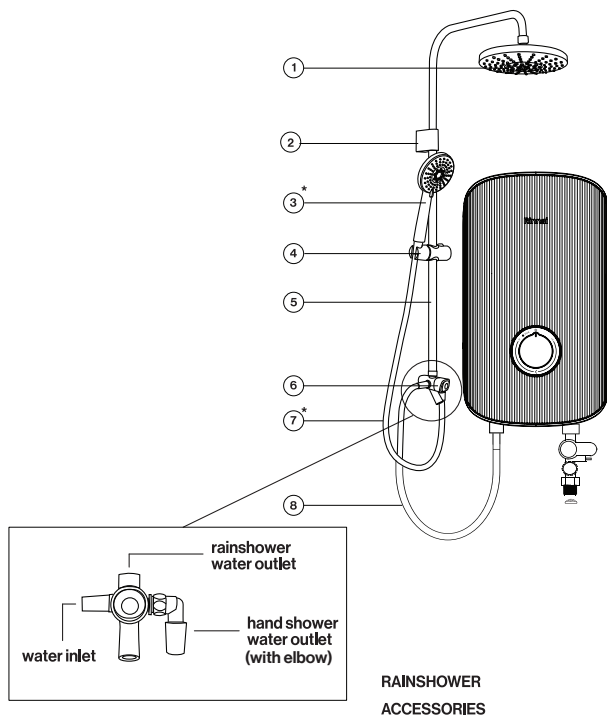

CAUTION
Please read the enclosed instructions completely before connecting, operating and installing this product.

(*) For Singapore Model Only

1. Rain Shower Head
2. Rail Support/ Wall Bracket
3. Handshower*
4. Adjustable Shower Holder
5. Sliding Rail
6. 3-Way Diverter Valve with Tap
7. PVC Hose 1.5m*
8. PVC Hose 1.0m

RAINSHOWER SET INSTALLATION PROCEDURE

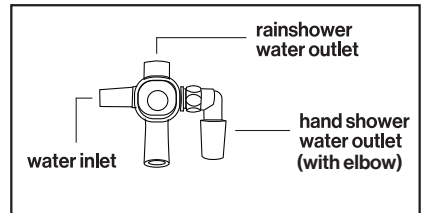
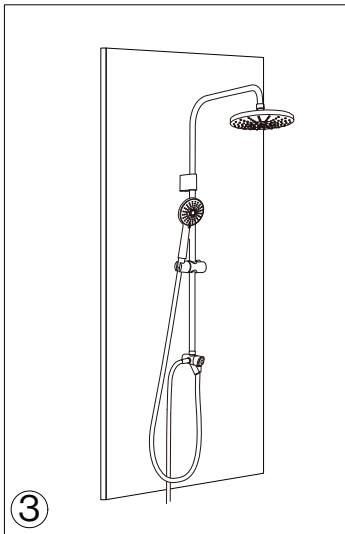
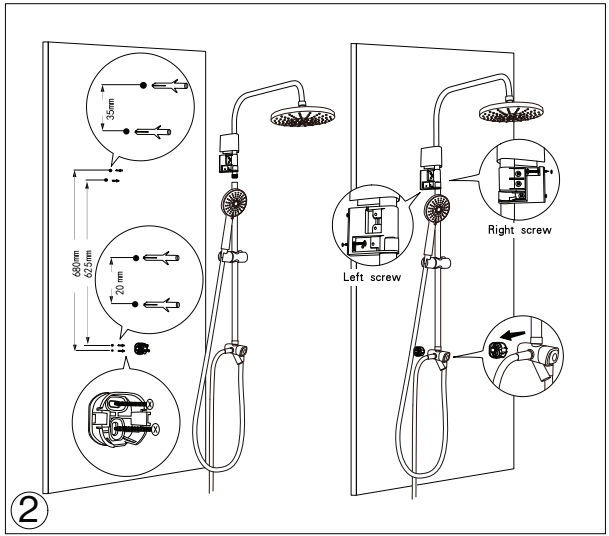
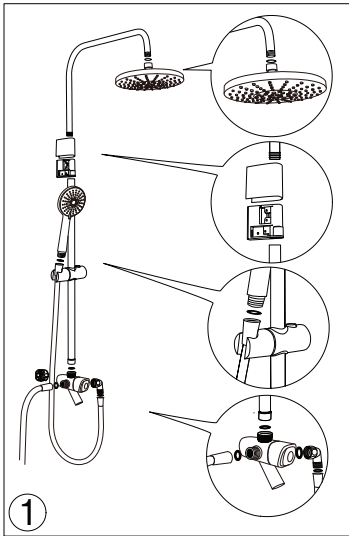

1. Do marking for the location of the lower and upper bracket.

Install the bracket holders on the wall.

2. Assemble the upper tube with rain shower and lower tube with divider.

3. Hook the assembled divider to the mounted bracket.

4. Tighten the screws and make sure all joints are completely connected to avoid leakage.

ACCESSORIES SPECIFICATION

TYPE	Rainshower Accessories
NET WEIGHT	1.8kg (RRS-C2XX & RRS-B2XX) 2.2kg (RRS-C23H & RRS-B23H)
WATER CONNECTION	1/2" BSP SINGLE POINT SYSTEM
DIMENSIONS	385mm x 1025mm

Note: The specification, actual product's cosmetic design and accessories parts shown are correct at the time of printing and may be subjected to change without prior notice.

Rinnai Holdings (Pacific) Pte Ltd

61 Ubi Road 1,
#02-20 & 21,
Oxley Bizhub
Singapore 408727

Tel. +65 6748-9011
Fax. +65 6745-9240
Email. service@rinnai.sg
Web. www.rinnai.sg

Rinnai (Malaysia) Sdn Bhd

D2-3, Block D2,
Pusat Perdagangan Dana 1,
Jalan PJU 1A/46, PJU 1A,
Ara Damansara,
47301 Petaling Jaya,
Selangor Darul Ehsan, Malaysia.

Toll Free. 1800 88 8180
Fax. 03 7832 0036
Email. customercare@rinnai.com.my
Web. www.rinnai.com.my