

MODEL:
RH-L3619-PGW

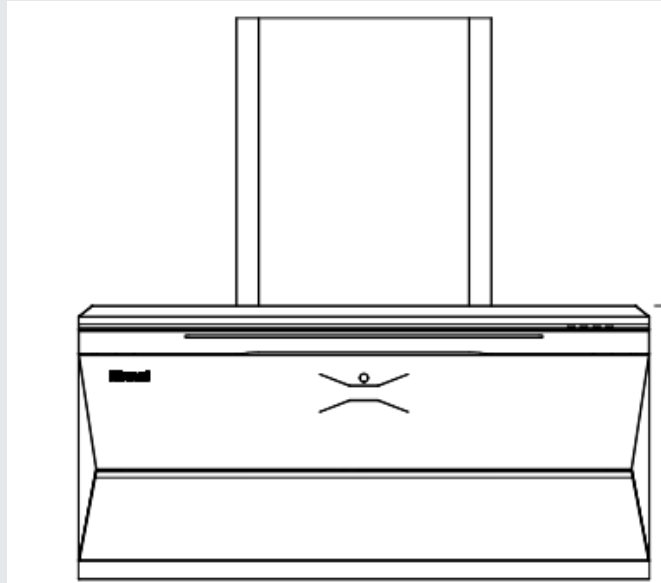

Cooker Hood
Instruction / Installation Manual

Rinnai

CONTENTS

Intended Use	Page 1
Safety Information Environmental	Page 2
Protection	Page 5
Operating Instructions	Page 6
Care and Maintenance	Page 11
Trouble Shooting	Page 16
Specification and Component List	Page 17
Installation Instructions	Page 18



IMPORTANT

To register your product warranty, please paste the serial numbers stickers enclosed with the packaging on your warranty card.

Please contact your local Rinnai After Sales Service Center should you require further assistance.

Intended Use

Please read this user manual thoroughly before attempting to use this appliance for the first time. This manual contains important information on safe installation, use and care of the appliance. Keep these instructions for reference and pass them on to future user.

This appliance can only be used safely if it is correctly installed according to the safety instructions. The installer is responsible for ensuring that the appliance works correctly at its installation location.

This appliance is intended for domestic use and household environment only. The appliance is designed to eliminate unpleasant odours from the kitchen. Do not use the hood for other uses than its specific purpose. Do not leave the appliance unattended during operation.

This appliance may be used by children over the age of 8 years old and by persons with reduced physical, sensory or mental capacity or by persons with a lack of experience or knowledge if they are supervised by someone who is responsible for their safety or have been instructed in how to use the appliance safely and have understood the risks involved in not using it properly.

Children must not play with the appliance. Cleaning and user maintenance must not be performed by children unless they are over 15 years of age and are supervised. Keep children below the age of 8 years old at a safe distance from the appliance and power cable.

Check the appliance for damage after unpacking it. Do not connect the appliance if it has been damaged during transport.



The manufacturer is not liable for any damage which is caused by improper use or incorrect operation.

Safety Information



Warning – Suffocation

- Packaging material is dangerous to children. Never allow children to play with packaging material.



Warning – Risk of Fire

- Do not operate the extractor hood without a grease filter. It is important to clean and/or replace the grease filters at appropriate intervals. Grease deposits build-up increases the risk of fire.
- Do not flambé or grill with an open flame directly under the extractor hood. Flames could be drawn up into the hood by the suction and the grease filters may catch fire. Do not install the extractor hood near a heat producing appliance for solid fuel (e.g. wood or coal) unless a closed, non-removable cover is available. There must be no flying sparks.
- Monitor cooking continuously as overheated oil increases the risk of self-ignition. Never use water to put out burning oil or grease. Switch off the cooker. Extinguish flames carefully using a lid, fire blanket or something similar.
- Never leave high naked flames under the extractor hood when it is in operation. An extractor hood installed above the cooker may become damaged or catch fire. Always cover lit burners with cookware.
- Ensure that the power supply cord is free from any heat source or sharp objects.
- Multiple plugs and extension cables must not be used. Overloading is dangerous and may cause a fire.
- Operating several gas burners at the same time gives rise to a great deal of heat. An extractor hood installed above the cooker may become damaged or catch fire.



Warning – Risk of Burns

- Accessible parts become very hot when in operation. Never touch hot parts. Keep children at a safe distance.
- Appliance becomes hot during operation. Allow the appliance to cool down before cleaning.



Warning – Risk of Injury

- Incorrect repairs are dangerous. Repairs should be attempted by our qualified technical personnel's only. If the appliance is defective, unplug the appliance from the mains or switch off the circuit breaker in the fuse box. Contact your local Rinnai After Sales Service Center for assistance.
- It is dangerous to modify any part of this appliance. Tampering with electrical connections or mechanical parts can cause operation faults and may put the user at risk.

- Do not use any high pressure cleaners or steam cleaners, which can result in an electric shock.
- Penetrating moisture may result in an electric shock. Clean the appliance using a damp cloth only. Before cleaning, pull out the mains plug or switch off the circuit breaker in the fuse box.
- Components inside the appliance may have sharp edges. Wear protective gloves.
- Lighting emitted by the LED lights are very dazzling and can damage the eyes. Do not look directly into lighted LED lights for longer than 100 seconds.



Warning – Risk of Electric Shock

- A defective appliance may cause electric shock. Never switch on a defective appliance. Unplug the appliance from the mains or switch off the circuit breaker in the fuse box. Contact your local Rinnai After Sales Service Center for assistance.
- Incorrect repairs are dangerous. Any repairs and replacements of damaged power cable or components should be attempted by our qualified technical personnel's only. Contact your local Rinnai After Sales Service Center for assistance. —
- Penetrating moisture may result in an electric shock. Clean the appliance using a damp cloth only. Before cleaning pull out the mains plug or switch off the circuit breaker in the fuse box.



Warning – Cause of Damage

- Always switch on the appliance while cooking to avoid condensation. Condensation can produce corrosion damage.
- Always replace faulty lights to prevent the remaining lights from overloading.
- Do not clean the controls with a wet cloth as this may risk damage due to ingress of humidity into the electronic circuitry.
- Clean all stainless steel surfaces in the direction of the grain only as incorrect cleaning may damage the stainless steel surface. Do not use any stainless steel cleaners for controls.
- Never use strong and abrasive cleaning agents as this may cause damage to the stainless steel surface.
- There is a risk of surface damage if you do not peel off the protective film. Remove the protective film from all parts of the appliance before using the appliance for the first time.

- This appliance is not intended for use by persons (including children) with reduced physical, sensory or mental capabilities, or lack of experience and knowledge, unless they have been given supervision or instruction concerning use of the appliance by a person responsible for their safety.
- Children should be supervised to ensure that they do not play with the appliance.
- If the supply cord is damaged, it must be replaced by the manufacturer, its service agent or similarly qualified persons in order to avoid a hazard.
- There shall be adequate ventilation of the room when the range hood is used at the same time as appliances burning gas or other fuels
- Clean the appliance every week according to “Cleaning the Metal Grease Filters”
- There is a fire risk if cleaning is not carried out in accordance with the instructions;
- Do not flame under the range hood;
- CAUTION: Accessible parts may become hot when used with cooking appliances
- The air must not be discharged into a flue that is used for exhausting fumes from appliances burning gas or other fuels
- The minimum distance between the supporting surface for the cooking vessels on the hob and the lowest part of the range hood is 650 mm
- Regulations concerning the discharge of air have to be fulfilled.

Environmental Protection

Energy Saving

- During cooking ensure that there is a sufficient supply of air to enable the extractor hood to work efficiently and with a low level of operating noise.
- Adjust the fan speed to the amount of cooking vapor produced during cooking. Only use intensive / booster mode when required. Operating the fan speed at lower levels consumes less energy.
- Switch off the extractor hood if you no longer require it.
- Clean and replace the grease filters at regular intervals in order to increase the effectiveness of the extractor hood and to prevent the risk of fire.

Disposal

- This appliance and its packaging are environmentally friendly and recyclable. Please help us to care for the environment by disposing the packaging in a proper manner and recycling any old appliances.
- Before disposing an old appliance, disconnect it from the power supply and cut the power supply cord to prevent hazards.

Operating Mode

Recirculating Air Mode



- The extractor hood fan draws in the cooking vapours and odors which is then clean by the grease filter. The clean air is then conveyed back to the kitchen via a vent opening in the hood.

Ducted Mode Mode

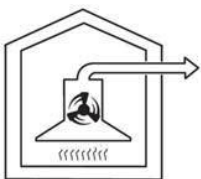

- In ducted mode, the extractor hood fan extracts the cooking vapours and passes them through the grease filter. The air then flows to the outside. The grease filter absorbs the solid particles in the cooking vapours.
Note: In this mode, only grease filters are installed (charcoal filter is optional).

Connection to Exhaust Air Pipe



- Attach Ø180mm pipe directly to the air outlet and secure appropriately.
- Connect pipe to the outdoor duct.

Operating Instructions

To achieve better air extraction, we recommend you to switch on the blower a few minutes before starting to cook. Leave it on for approximately 15 minutes after cooking or till all cooking smell is completely removed.

Switch control: *Touch the sensor buttons gently to operate this appliance.*

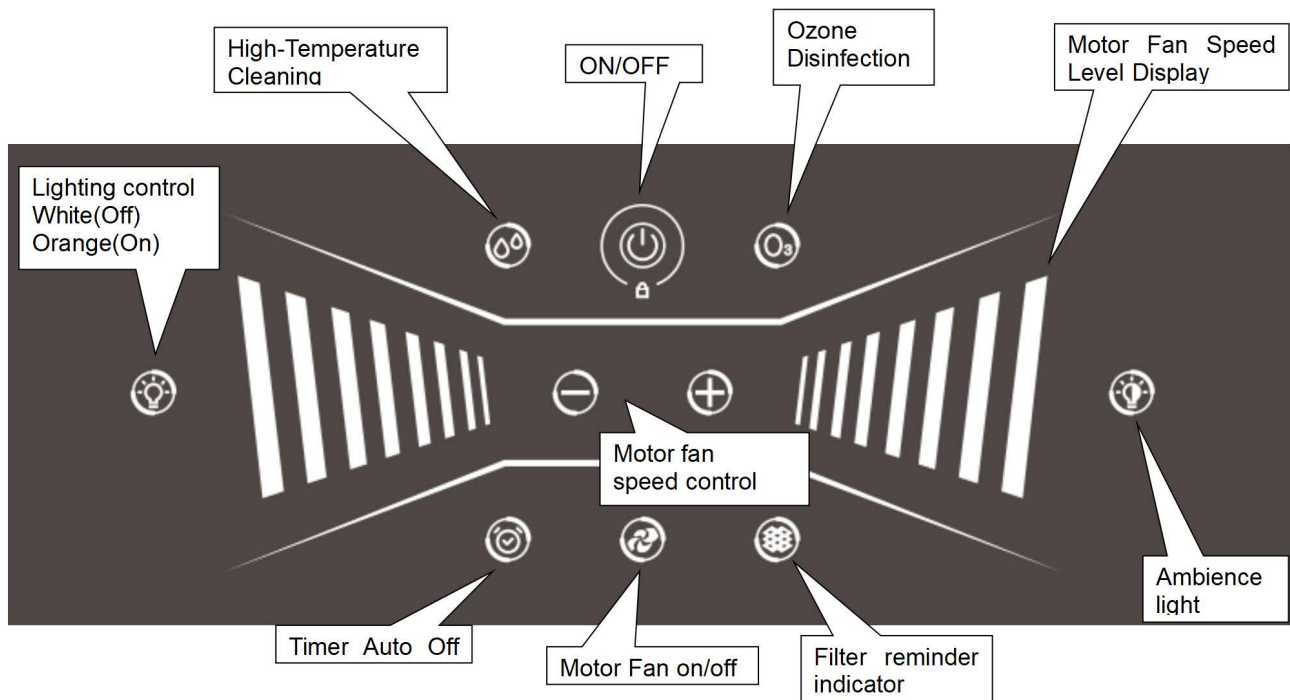

Power ON/OFF Function:



1. Power On/Off Button:

Press briefly to turn the hood on or off.

When turned off, only the power icon is visible in white.

On startup, the power indicator glows orange, and function keys illuminate in white (turning orange when selected or in use). The hood automatically shuts down if there's no activity within 10 seconds.

2. Deactivating Controls (For Cleaning):

When the hood is off, long-press the power button for 3 seconds to lock the screen. Icon blinking in orange. After locking, no functions, including gestures, can be used.

After cleaning, long-press for 3 seconds again to not lock, returning to the powered-off state.

3. Deactivating Controls (During Regular Operations):

When the hood is functioning, long-press the power button for 3 seconds to lock the screen.

While locked, no functions, including gestures, are accessible to prevent accidental change of operations.

Long-press for 3 seconds again to unlock.

Wave Control Function:

1. To select fan speed, press on the increase and decrease fan setting symbol to select the require fan speed. (1 – 2 – 3 – P) (P - 3 - 2 - 1).

To set to Booster Mode, after approximately 10 minutes it will automatically switch back to fan setting 3. If you want to disable the booster function before the preset time touch on the fan setting decrease symbol.

Note: When using booster function the delay timer cannot be use at the same time.

High-Temperature Cleaning Function:



1. Activation:

Power on the device and activate high-temperature cleaning by pressing and holding this button for 3 seconds.

- The indicator light turns orange, signifying the start of a process that includes activating the control relay for the heating element for 20 minutes.

Subsequently, the relay closes, and the fan operates at speed 4 for 1 minute (to facilitate drying). The entire sequence concludes with an automatic exit and shutdown.

2. Operation and Controls:

While in operation, the decorative lights transition automatically.

To manually end the operation, either hold this button for 3 seconds or briefly press the power button.

During operation, you have control over the lighting and decorative lights. However, the fan, ozone, filter, and gesture switch buttons remain inactive.

Ozone Disinfection Function:



1. Activation:

With the device powered on, press, and hold this button for 3 seconds to activate the ozone disinfection function.

The indicator light turns orange, initiating a process that involves opening the relay for the 220V ozone generator and the fan.

The system operates for 10 minutes, after which the relays for the ozone generator and fan close. Following this, the fan operates at speed of 1 for 5 minutes for ventilation.

The entire sequence ends with an automatic exit and shutdown.

2. Operation and Controls:

During operation, the decorative lights automatically transition.

To stop, either press and hold this button for 3 seconds or briefly press the power button for an automatic exit and shutdown.

While in operation, you can control the lighting and decorative lights, but the fan, high-temperature cleaning, filter, and gesture switch buttons are not functional.

Lighting function



- 1.white
- 2.Warm white
- 3.Warm
- 4.Off

Ambience Lighting Function:



1. Color Selection:

After powering on, activate the decorative light function by short pressing the icon 1 second.

The red light (R).

The green light (G).

The blue light (B).

→ Off.

2. Cycle Operations:

After turning on, the indicator light will glow orange.

For changing the setting cycles, press briefly to keep changing the lighting state.

To exit the setting, long-press this button for 3 seconds, turning this control button off again.

Fan speed increase/decrease:

1. Speed Adjustment:

After turning on, press the motor button (the motor directly enters speed 1). Use the "+" and "-" buttons to adjust speeds, cycling through 1-2-3-4 or 4-3-2-1.

2. Limit Alerts:

If you try to increase speed beyond level 4, you'll hear two beep sounds, indicating the maximum speed. If you try to decrease speed below level 1, you'll hear two beep sounds, indicating the minimum speed.

Delay timer:

1. Setting the Timer:

During normal operation, press the timer button briefly once. The indicator light will flash, indicating a 3-minute timer. Press the timer button briefly a second time, and the indicator light will stay on, indicating a 7-minute timer.

2. Automatic Shutdown:

The device will automatically shut down after the designated timer period.

After activating this timer function, while counting down, the indicator light will turn orange. If you try to decrease speed below level 1, you'll hear two beep sounds, indicating the minimum speed. To manually off timer function continue to press until indicator change to white.

Motor Fan Function:

Turning On/Off:

Press the motor button briefly once to turn the fan on or off.

Speed Adjustment:

After turning on, press the motor button to directly set the fan to speed 1.

Use the "+" and "-" buttons to adjust speeds, cycling through 1-2-3-4 or 4-3-2-1.

Filter Reminder Function



1. Filter Status Indication (After 90 Hours):

In the powered-off state, when the motor accumulates 90 hours of operation, the indicator light will flash. Press the filter reminder button briefly once, and the indicator light will stay on continuously. With the indicator continuously on, open the lower panel to access and clean the filter beneath. After cleaning, long-press for 3 seconds to exit and return to the powered-off state. The filter reminder timer is reset to zero, and counting starts anew towards the next 90 hours.

2. Manual Cleaning (Before 90 Hours):

If you need to clean the filter before reaching 90 hours of operation, long-press the button for 3 seconds. With the indicator continuously on, open the lower panel to access and clean the filter beneath.

After cleaning, long-press for 3 seconds again to exit and return to the powered-off state.

3. During Operation:

While in operation, the indicator light will glow orange.

You can control the lighting and decorative lights using the respective buttons.

The motor, ozone, high-temperature cleaning, and gesture switch buttons are not operational.

Fan Speed Levels Display:



Speed Level 1 (1-2):

Illuminate the light strip for levels 1 and 2 blinking.

Speed Level 2 (1-4):

Illuminate the light strip for levels 3 and 4.

Speed Level 3 (1-6):

Illuminate the light strip for levels 5 and 6.

Speed Level 4 (1-8):

Illuminate the light strip for levels 7 and 8.

Running Light Effect (Starting from Level 2):

Starting from speed level 2, create a running light effect where the lights move in sequence from 2-3-4.

Care and Maintenance



Warning: Before carrying out any cleaning or maintenance activities, ensure that the appliance is disconnected from the main power supply.

Components inside the appliance may have sharp edges. Wear protective gloves.

Cleaning Agents

To ensure that the different surfaces are not damaged by using the wrong cleaning product, follow the instructions in the table. Do not use any of the following:

- Harsh or abrasive cleaning agents, e.g. scouring powder or liquid scouring cleaner
- Cleaning products with a high alcohol content
- Hard scouring pads or cleaning sponges
- Pressure washers or steam cleaners
- Cleaning products that dissolve limescale
- Aggressive all-purpose cleaning products

Note: Use a new soft sponge or cloth. Do wash thoroughly before each use. Never use a wire sponge or brush as it may leave scratches or other marks and follow all instructions and warnings included with the cleaning products.

Surface	Instruction
Stainless Steel	Clean with warm soapy water using a soft damp sponge or damp cloth Wipe off with a dry lint free cloth to avoid smearing or staining on the hood Clean in the direction of the grains only
Painted Surface	Clean with warm soapy water using a soft damp sponge or damp cloth Wipe off with a dry lint free cloth Do not use any stainless steel cleaner
Aluminium and Plastic	Clean with warm soapy water using a soft damp sponge or soft damp cloth Wipe off with a dry lint free cloth
Glass	Clean with a solution of warm water and a little washing up liquid using a soft damp sponge or damp cloth Wipe off with a dry lint free cloth Do not use a scraper
Controls	Clean with warm soapy water using a soft damp sponge or soft damp cloth Wipe off with a dry lint free cloth Never clean the controls with a wet cloth as there is a risk of damage to the electronics

Metal Grease Filter



Warning: It is important to regularly clean and/or replace the metal grease filters at appropriate intervals as grease deposits build-up increases the risk of fire. Do not operate the extractor hood without any grease filter installed.

Components inside the appliance may have sharp edges. It is advisable that you wear protective gloves.

Cleaning the Metal Grease Filter (Fig. 1)

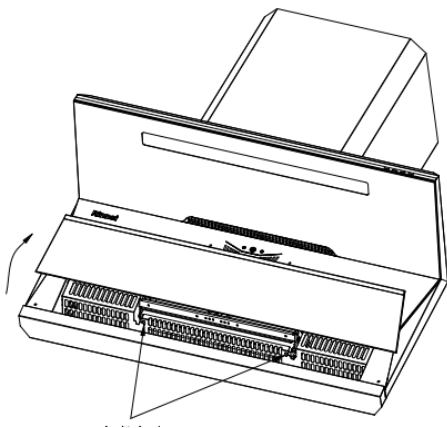

Fig. 1

- Open control panel glass to clean filter, no need to change.
- Open lower panel glass to disassemble screw to clean the filter

Cleaning the Metal Grease Filters

- Do not use any aggressive, acidic or alkaline cleaning products.
- The metal grease filters must be removed and cleaned every 4 weeks depending on the frequency of usage or when the orange indicator light blinks on the control panel display window.
- When cleaning the metal grease filters, also clean the metal grease filter holder and all accessible parts in the appliance using a damp cloth.
- The metal grease filters can be cleaned in the dishwasher or by hand.
 - If by hand washing: Soak the filters in warm detergent solution (approx. 40 °C) to simplify the removal of grease. Brush the metal grease filters, rinse thoroughly and leave it to dry before refitting.
 - If by dishwasher: Use normal domestic dishwashing detergent, select an appropriate wash program (no more than 70 °C) , do not clean heavily soiled grease filters together with any cookware. Place the metal grease filters in the dishwasher leaving plenty of space around them. Leave it to dry before refitting.

Note: A slight discolouration of the metal grease filter may occur. This discolouration has no effect on the performance of the metal grease filters.

Installing the Metal Grease Filter

- Insert back the metal grease filter and lock it in place, at the same time take hold of the metal grease filter from underneath using your other hand to insert into the grease filter holder, make sure the metal grease filter is positioned correctly.
- If the metal grease filter has not been inserted correctly, open the lock and reinsert it again.

Cleaning the Appliance Body

- Clean the extractor hood using warm detergent solution and a soft damp cloth. After cleaning, dry it using a lint free cloth.
- Avoid using corrosive or abrasive products that could damage the surface.
- Do not clean the controls with a wet cloth as this may risk damage due to ingress of humidity into the electronic circuitry.

Oil Collector Cup

Cleaning the Metal Oil Collector Cup (Fig. 2)

- Hold the bottom of the oil cup with both hands and pull it outwards.
- After cleaning, hold the oil cup with both hands, hang it on both sides, and push it inwards to complete the installation.

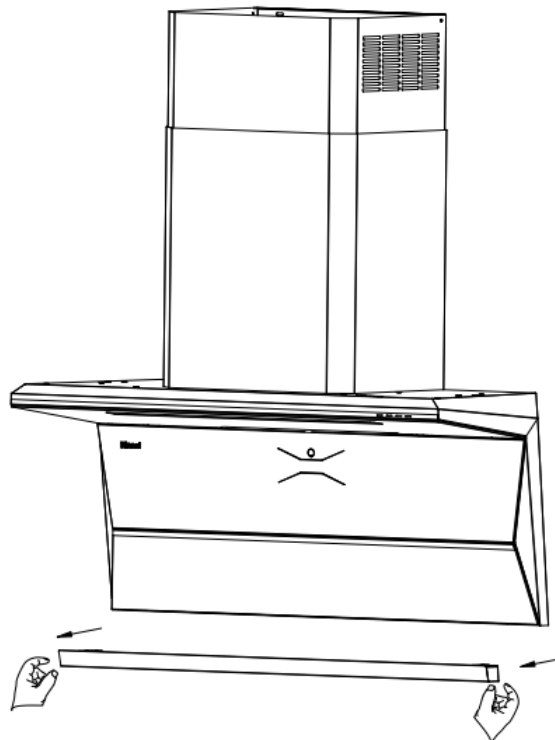

LED Lights

Defective LED lights can only be replaced by the manufacturer, Rinnai customer service or their authorized after sales service agents only.

- Lamp type:LED Shape
- Description:Stripe.....
- Image:scription:Stripe



- Max wattage of a potential replacement lamp:6W
 - Rated voltage or voltage range of lamp:12V
- Pre-heat starting fluorescent lamps starter replacement details,please see below picture;



- The type of lamp cap: No cap
- Nominal dimension(s) of lamp:600*55mm

Charcoal Filter (*where applicable*) (Fig. 3)

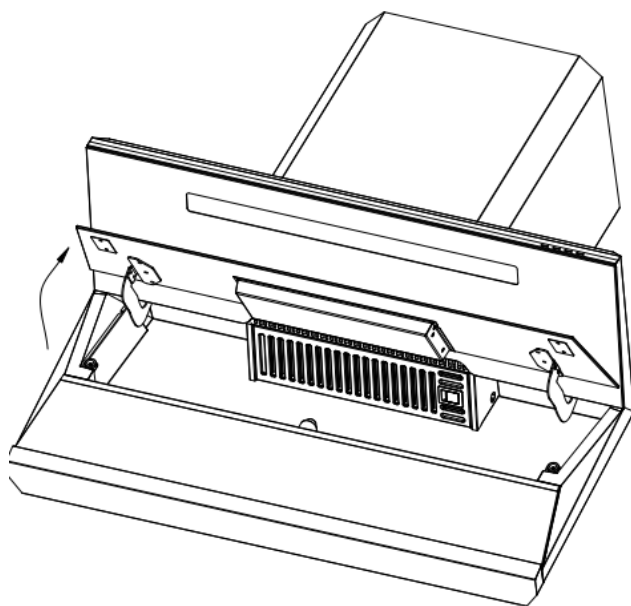

Fig. 3

Please disconnect the power cable, and open the glass door to change the charcoal filter.

- Remove the charcoal filter from the housing as shown. Turn the charcoal filter anti clockwise and pull down.
- Reverse the procedure when refitting the new charcoal filters.

Note: The charcoal filter should be replaced when you see the white indicator light lights up on the control panel display window or if it is noticeable dirty or discoloured, usually after 2 months depending on the conditions of use.

These charcoal filters are not washable and cannot be restored. To ensure that this appliance functions effectively, regular maintenance is necessary as clogged filters restrict airflow and may cause the motor to overheat.

Trouble Shooting



Warning: Incorrect repairs are dangerous. Repairs should be attempted by our qualified technical personnel's only. If the appliance is defective, unplug the appliance from the mains or switch off the circuit breaker in the fuse box. Contact your local Rinnai After Sales Service Center for assistance.

Problem	Possible Cause	Solution
The Extractor Hood Does Not Work	No electricity supply	Check power plug is connected and main power switch is turned on
	Faulty Fuse	Check fuse box of the extractor hood to make sure fuse is not blown
Whirring Sound	Foreign object may be in contact with fan blade	Please contact your local Rinnai After Sales Center
Motor is Running but No Air Flow	Non return flap might be jammed	Please contact your local Rinnai After Sales Center
Lights are not Working	The LED lights are defective	Please contact your local Rinnai After Sales Center
Poor airflow	Grease filters clogged with grease build-up	Clean the grease filters and refit when dry
	Charcoal filters clogged with grease build-up	Replace charcoal filters with new sets
Hood suction is not effective	Inadequate ventilation	Ensure that the kitchen is sufficiently ventilated to allow entry of fresh air
	Charcoal filters are not installed	Install charcoal filters for setting in recirculation mode

If problem persists after the above checks, please contact your local Rinnai After Sales Service Center for assistance.

Please quote the model number of your appliance as shown on the rating plate. (Fig. 4)

For service calls under warranty, please note that it is necessary to produce your proof of purchase and valid warranty card.

Please be aware that a visit by an after-sales engineer will be charged if a problem turns out to be the result of user's error even during the warranty period.

Note: Rating plate is for illustration purpose only and its specifications may vary across other models.

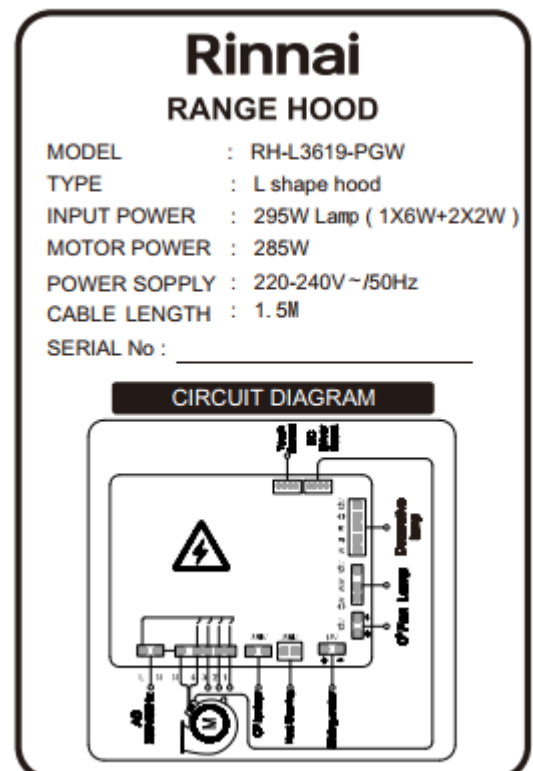
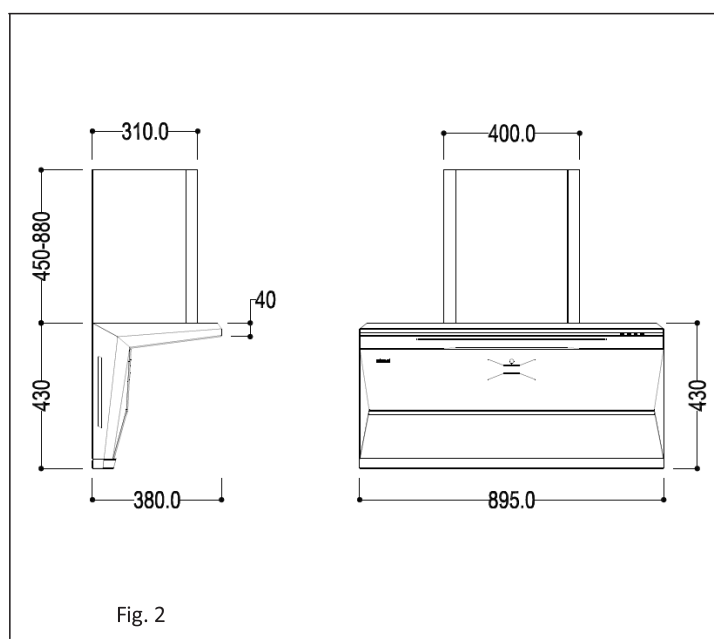

Fig. 4

SPECIFICATIONS



Model	RH-L3619-PGW
Voltage	220V - 240V / 50Hz
Power of Motor	285W motor
Power of Lamp	1X6W lamp 2X2W decoration light
Cable Length	1.5m
Appliance Dimension (W x D x H)	895x380x880~1310mm
Note: The manufacturer reserves the right to change any technological improvement or modification without prior notice.	

COMPONENTS

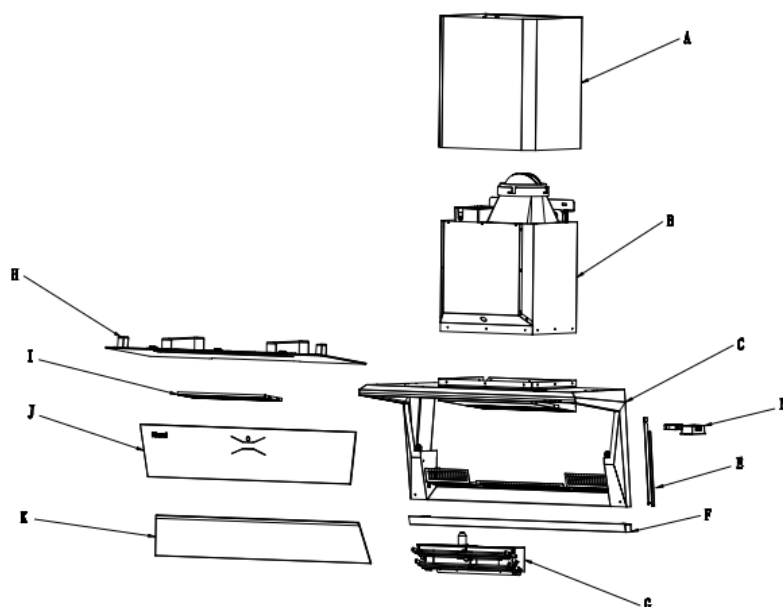

Re	Qty	Product components
A	1	Duct
B	1	Motor housing
C	1	Body
D	1	Ozonator
E	2	Ambient light
F	1	Oil cup
G	1	Lifting system
H	1	Light panel glass assembly
I	1	Aluminum filter
J	1	Control panel glass assembly
K	1	Lower panel glass assembly
	Qty	Installation components
	5	Expansion tube 8*40
	5	Screw ST5*40
	2	Screw M6*60
	2	Screw STB4*8

Installation Instructions

Safety and General Information

- Read these instructions carefully. Check the appliance for damage after unpacking it.
- The appliance can only be used safely if it is correctly installed according to the safety instructions. The installer is responsible for ensuring that the appliance works correctly at its installation location.
- If the supply cord is damaged, it must be replaced by the manufacturer, its service agent or qualified technical personnel in order to avoid a hazard.
- The surfaces of the appliance are easily damaged. Avoid damaging them during installation.
- This appliance is intended to be mounted on the wall.
- The extractor hood can be installed over any gas and electric cooktop. Minimum installation height from the bench top to the bottom of the hood is 700-750mm . Fig. 5
- Always mount the extractor hood over the center of the hob.
- Ensure that the appliance is installed in a location with good permanent ventilation.
- When making electrical connections, check that the mains voltage and frequency corresponds to the technical information shown on the rating plate.
- Electrical connection must be made in accordance to local standards only. Check that the voltage in your area is correct before plugging in.
- Use an electrical connector with earth that is correct for your location. The electrical connection of this appliance must be connected to earth (where applicable):

→ Green & Yellow = EARTH

→ Blue = NEUTRAL

→ Brown = LIVE

Fig. 5

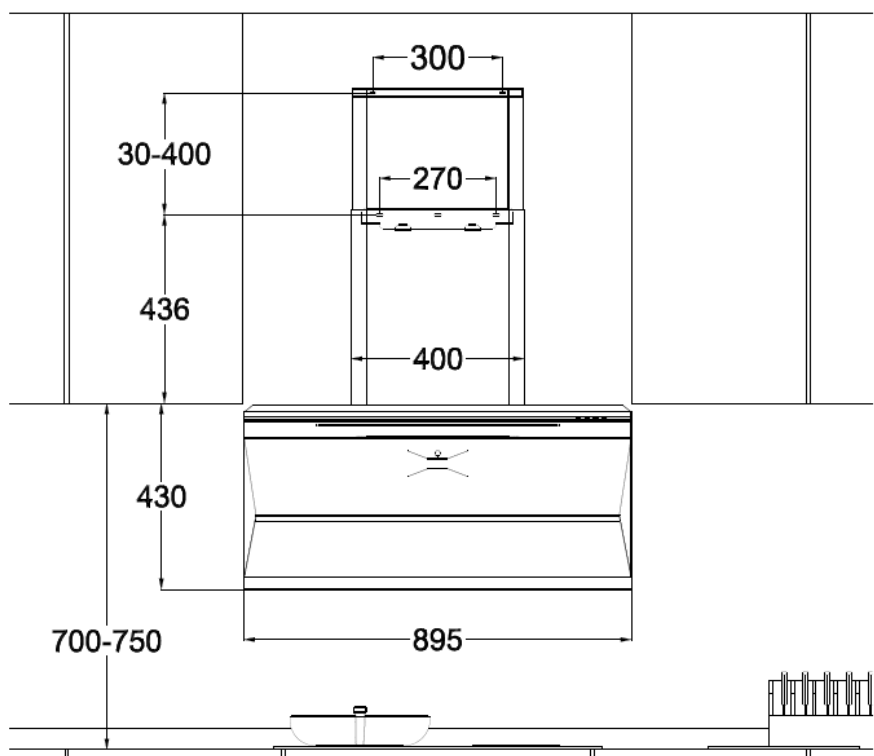

2. Fix the hook and the duct fixing plate according to the installation height:

Expansion tube 8*40 5pcs

Screw ST5*40 5pcs

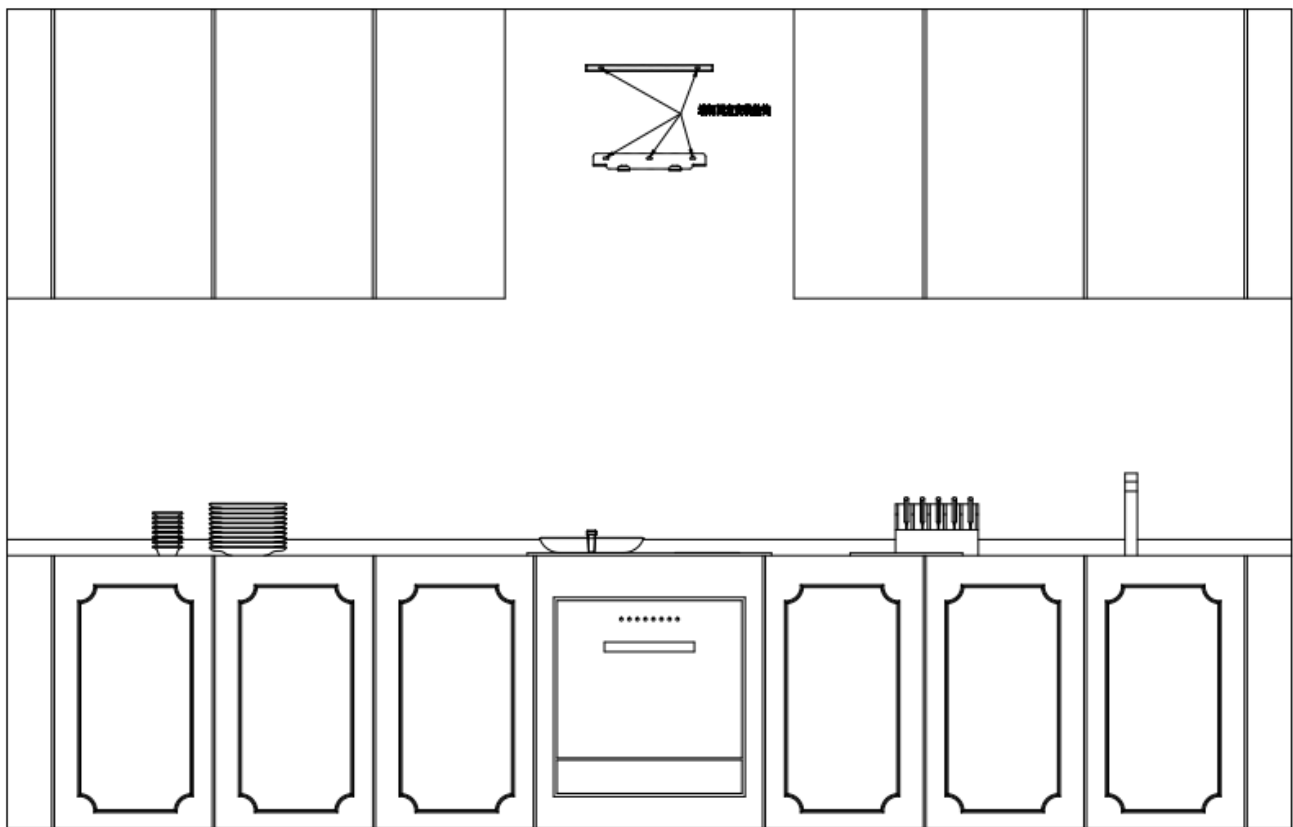

3. Install hood

~Adjust the hood installation level, need 2pcs M6*60

~Install the pipe

~Fix the top chimney and fixation board with 2pcs STB4*8

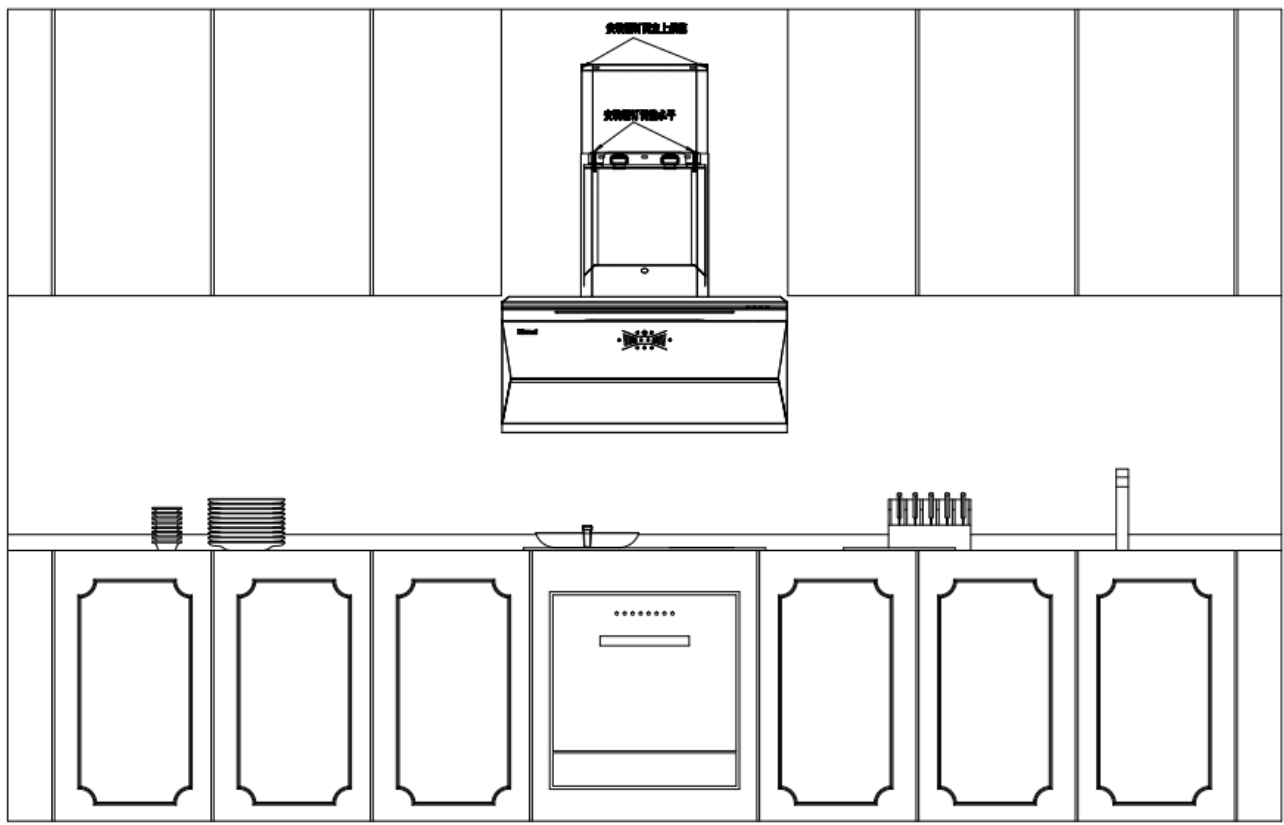



Warning

Components inside the appliance may have sharp edges. Wear protective gloves.

- The extractor hood may fall down if it has not been properly fastened in place. All fastening components must be fixed firmly and securely.
- The extractor hood is heavy. To move the appliance 2 people are required. Use only suitable tools and equipment.
- Changes to the electrical or mechanical assembly are dangerous and may lead to malfunctions. Do not make any changes to the electrical or mechanical assembly.
- Components inside the appliance may have sharp edges. These may damage the connecting cable. Do not kink or pinch the connecting cable during installation.
- It must always be possible to disconnect the appliance from the electricity supply.
- The appliance must only be connected to a protective contact socket that has been correctly installed.
- The mains plug of the mains power cable must be easily accessible after installation of the appliance. If this is not possible, an all-pole isolating switch must be integrated into the permanent electrical installation
- The permanent electrical installation must only be wired by a professional electrician.

Note: The manufacturer will not be held liable for any damages resulting from improper installation nor failure to adopt proper safety measures during installation and operational use of the appliance.

Checking the Wall

- Do ensure the wall must be level, vertical and adequately loadbearing.
- The depth of the bore holes must be the same length as the screws. The wall plugs must have a secure grip.
- The enclosed screws and wall plugs are suitable for solid brickwork. Suitable fasteners must be used for other structures (e.g. plasterboard, porous concrete, perforated bricks).

Preparing the Installation

Ensure that there are no electrical wires, gas pipes or water pipes in the area where holes are to be drilled.

Step 1 (Fig. 6 & Fig. 6. 1)

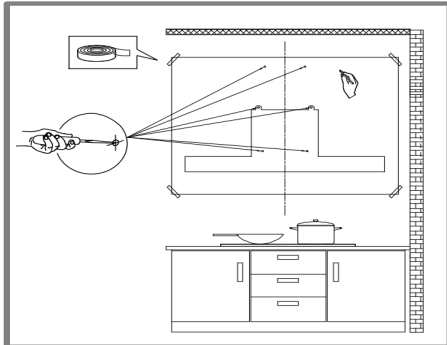

Fig. 6

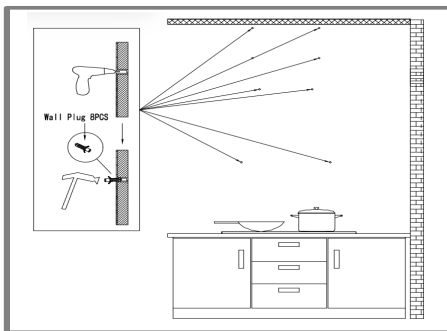

Fig. 6. 1

- Determine where the extractor hood should be positioned and lightly mark where the lower edge of the appliance should be on the wall. Determine where the middle should be based on the hob.
- Place the template against the line drawn on the wall and tape it in place. Mark the area where the screws should be inserted. (Fig. 6)
- Drill 8mm diameter holes to a depth of 40mm for fastening the appliance, remove the template and press in the wall plugs flush with the wall and mount the screws (Do not tighten). (Fig. 6. 1)

Attaching and Aligning the Extractor

Hood Step 2 (Fig. 7)

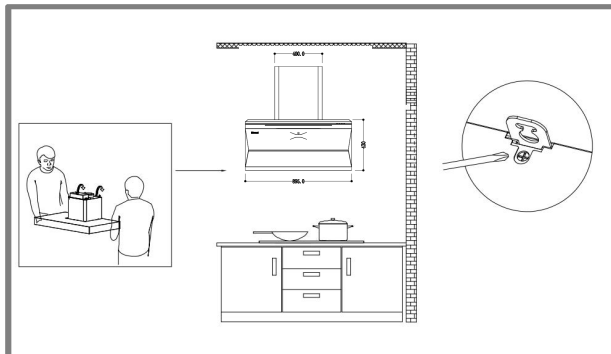

Fig. 7

- Mount the appliance onto the wall and do ensure that it is properly engaged with the mounting screws 3 & 4 (Fig. 7)
- If there is a need to realign the appliance, adjust the screws on the top of the motor housing (Fig. 7)

Attaching the Flue Ducts Step

4 (Fig. 8, Fig. 8. 1, Fig. 8. 2)

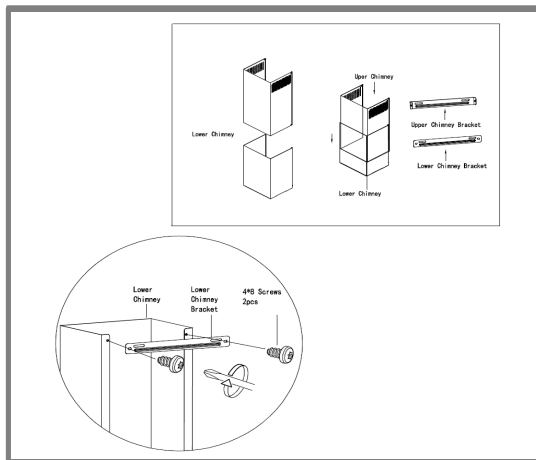

Fig.8

- Secure the mounting bracket onto the screws firmly 1 & 2 and place the outer flue duct onto the appliances. (Fig. 8).
- Slide the outer flue duct section downwards, attached it to the left and right of the retaining bracket to engage it. (Fig. 8)

Note: To prevent scratches, lay paper over the edges of the lower flue duct to protect the surface.

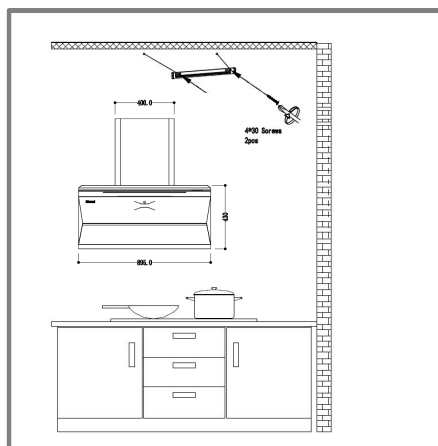

Fig. 8. 1

- Slide the inner flue duct to the required height and mark where the screws should be inserted and drill 8mm diameter holes to a depth of 40mm and secure the mounting bracket onto the screws provided. (Fig. 8.1)

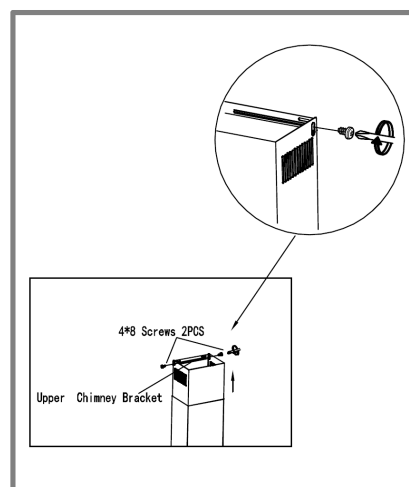
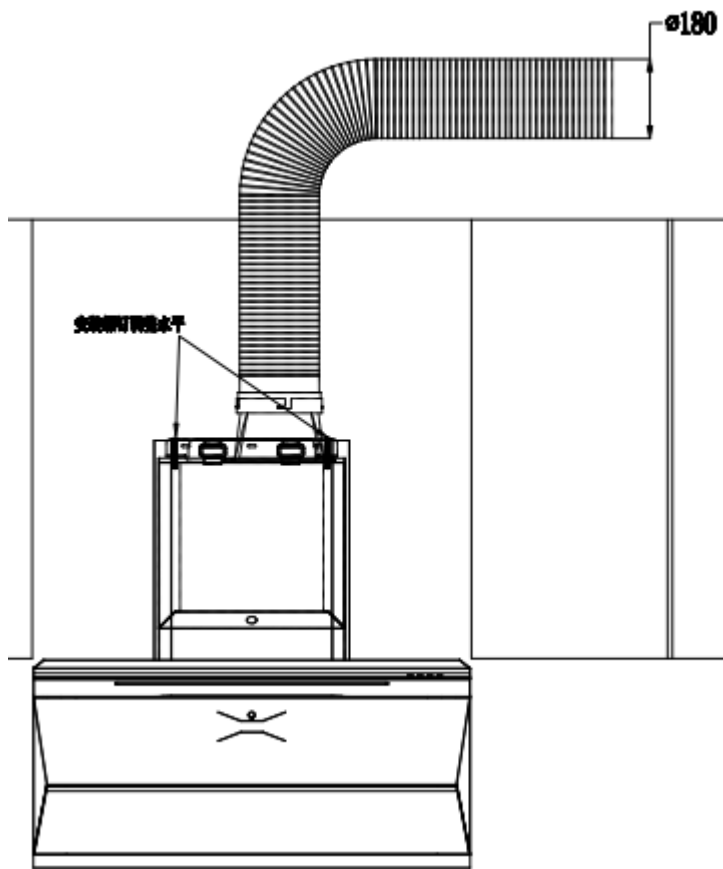

Fig. 8. 2

- Use the provided ST5*25 screws to attach the inner flue duct on the left and right sides of the bracket. (Fig. 8. 2)

Add the lock ring and ensure that the air duct cannot be disassembled with a force of 50N.(Fig. 9)



Add sealing plate installation requirements to ensure that the electric control box cannot be touched
(Fig. 10)

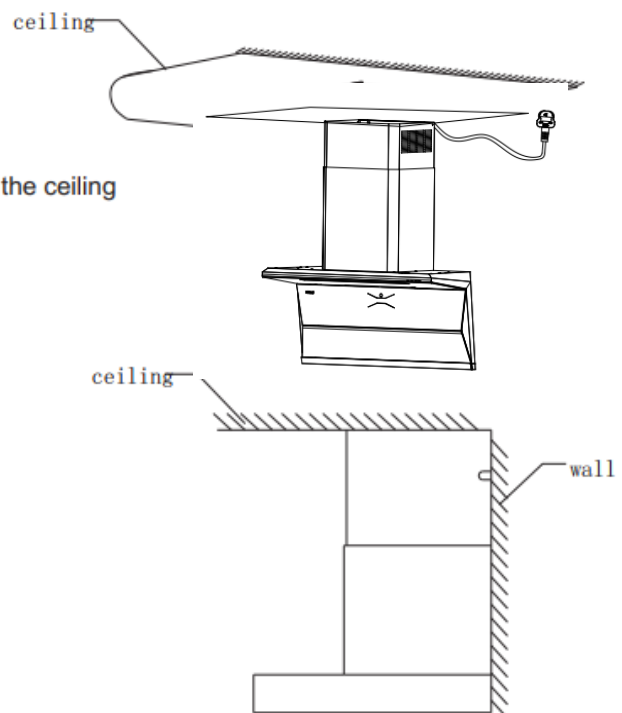

The top of the cooker hood should be raised to the top of the ceiling

Rinnai Customer Care Centres

China | 中国

Guangzhou Rinnai Gas & Electric
Room 2805, No.31 Jianghe Building,
Tianshou Road, Guangzhou, China
广州林内燃具电器有限公司
中国广州天河区天寿路 31 号江河大厦 2805 室
Tel 电话 : (86) 20 3821 7976
Email 邮箱 : grrjdq@gzrinnai.com.cn
URL 网址 : www.gzrinnai.com.cn

Indonesia

PT. Bhakti Idola Tama
Jl. Raya Perjuangan No.21
Komp. Ruko Sastra Graha No.11-13
Jakarta 11530
Tel : (62) 0800 1 889 889 (Customer Care) /
(0815 112 99999 (SMS Center)
Email: customercare_bit@yahoo.com
URL: www.rinnai.co.id

Macau | 澳門

Rinnai Appliance Service Center
Nam Kwong Petroleum & Chemicals Co., Ltd
Avenida do Dr. Rodrigo Rodrigues, Nam Kwong
Building, 17/F, Macau
Phone 電話 : (853)83911712
Fax 傳真 : (853)28330856
URL 网址 : www.rinnai.com.hk/

Malaysia

Rinnai (M) Sdn Bhd
Unit 2-8, Subplace Boulevard, Pusat Komersil
Vestland, No.6,Jalan Juruanalisis U1/35,
Seksyen U1, 40150 Shah Alam, Selangor Malaysia
Fax +:603 5038 8905
Tol Free :1800-88-8180

Myanmar | မြန်မာ

Myanmar Kowa International Co., Ltd
No.199, Ground Floor, 34th Street (Upper Block),
Kyauktada Township, Yangon, Myanmar
အမှတ် (၁၉၉)၊ ၃၄ လမ်း (အပေါ်ဘလောက်)၊
ကျောက်တံတားမြို့နယ်၊ ရန်ကုန်မြို့။
Tel ဖုန်း : (95-1) 245925 / 246304 / (95-9) 7300 7773
Fax ဖက်(စ်) : (95-1) 245925
Email အီးမေးလ် : marketing@myanmarkowa.com

Philippines

3rd floor, M.I.C. Building 72 Bukidnon Street Brgy.
Ramon Magsaysay Bago Bantay, Quezon City.
Tel no.: (02) 2512547, (02) 2512438

Singapore

Rinnai Holdings (Pacific) Pte Ltd
61 Ubi Road 1 #02-20 & 21
Oxley Bizhub Singapore 408727
Tel : (65) 6748 9478
Fax : (65) 6745 9240
Email : service@rinnai.sg
URL : www.rinnai.sg

Thailand | ประเทศไทย

Rinnai (Thailand) Co., Ltd. / Lucky Flame Co., Ltd.
61/1 Soi Kingkaew 9, Kingkaew Rd.
Racha Thewa, Bangphli, Samutprakarn 10540, Thailand
บริษัท รินไน (ประเทศไทย) จำกัด
เลขที่ 61/1 ซอยกิ่งแก้ว 9 ถนนกิ่งแก้ว ตำบลราชาเทวะ
อำเภอบางพลี จังหวัดสมุทรปราการ
ประเทศไทย 10540
Tel : (66) 2 3124330-40
Email : lucky02@luckyflame.co.th
URL : www.luckyflame.co.th

Vietnam | Việt Nam

Rong Viet Commerce Company Limited
120 3/2 Street, Ward 12, District 10,
Ho Chi Minh City, Vietnam
Công Ty TNHH Thương Mại Ròng Việt
120 Đường 3/2, Phường 12, Quận 10,
TP. Hồ Chí Minh, Việt Nam
Tel : (84) 8 3862 3409
Fax : (84) 8 5404 1964
Email : info@rongviet-rinnai.com
URL : www.rongviet-rinnai.com