

MODEL:

RI-522SS RI-522SC

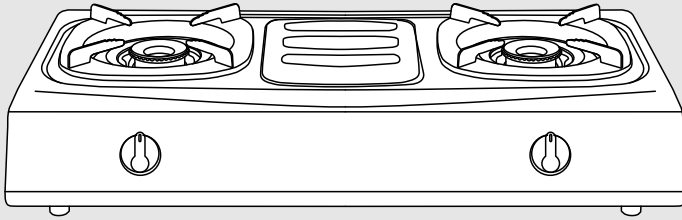

Gas Table Cooker

Instruction for use

Rinnai

INSTRUCTIONS FOR USE

Safe and easy to operate, the burners will ignite automatically when the control knobs are pushed and turned in counter-clockwise direction. For best results from your Rinnai Gas Cooker, Please read the instruction given below carefully prior to operating the unit.

NAME OF PARTS

MODEL:
RI-522SS
RI-522SC

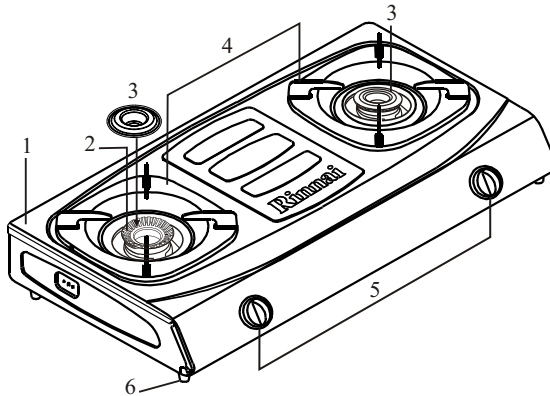

1. Top Plate
2. Sun Burner
3. Top Burner Cover
4. Pan Support
5. Ignition Knob
6. Rubber Leg

SPECIFICATION

Model	Dimension			Net. Weight	Gas Consumption / h						Gas Inlet Connection
	Height	Width	Length		LPG (30 mbar / 3.0 kPa)			NG (25 mbar / 2.5 kPa)			
					LHS	RHS	Total	LHS	RHS	Total	
RI-522SS	149 mm	700 mm	396 mm	3.5 Kg	1.9 kW	1.9 kW	3.7 kW	1.9 kW	1.9 kW	3.7 kW	Rubber Hose Ø9.5 mm
RI-522SC	149 mm	700 mm	396 mm	3.6 Kg	1.9 kW	1.9 kW	3.7 kW	1.9 kW	1.9 kW	3.7 kW	

Pan Diameter	Max. 28 cm	Heavy weight max. each burner
	Min. 14 cm	20 Kg

Automatic Ignition (Piezo Magnetic)

PREPARING THE UNIT FOR USE

1. Check to ensure that all parts of the gas cooker are complete.
2. A minimum clearance is 15 cm from the side / back wall and 100 cm from the ceiling is required when installing the gas cooker. The gas cooker shall be placed in good ventilated room. (Figure No. 1)
3. Using a screwdriver affix the rubber legs with the provided screw into the designated hole on the gas cooker bottom. (Figure No. 2)
4. Insert the ignition knob in its correct position by pushing it inward firmly. (Figure No. 3)
5. Place the pan support that are common on the right and the left. (Figure No. 3)
6. Push the rubber hose on to the gas pipe and regulator as far as it will go. Secure the hose using a hose clamp.
7. Open the main valve on the gas cylinder. In the event of gas leak, close the main valve immediately and open the windows in the room to allow the gas to escape.

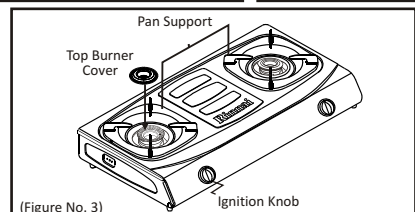
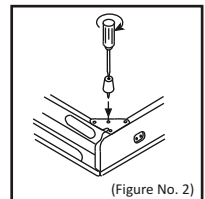
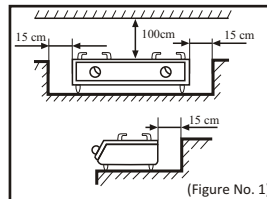

OPERATING THE UNIT

1. Igniting the burner and adjusting the flame

*) Open the valve on the cylinder

Maximum Flame

➤ Push the knob in fully and turn counter clockwise to "MAX", in this position burners will burn fully.

Minimum Flame

➤ From "Max" position, turn the knob to the left on "MIN" position, where the burner will burn smaller.

➤ Flame is adjustable between the "MAX" and "OFF" positions by slowly turning the knob to the "OFF" position. (Figure No. 4)

2. If no flame, turn back the knob to "OFF" position, repeat the ignition procedure as above.

3. Air Control

For good flame, turn damper upward or downward until blue colored flame is obtained. (Figure No. 5)

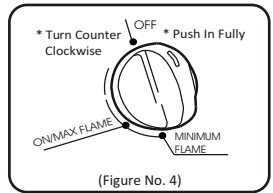

(Figure No. 4)

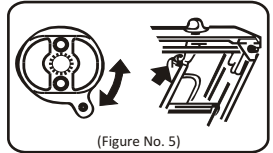

(Figure No. 5)

MAINTENANCE AND CARE

1. Using a brush or cord, clean the burner surface of any dust adhering to these part. (Figure No. 6)

2. Wipe clean the pan support, and other stainless steel with a small amount of soapy water.

Don't use the alcohol or gasoline, because can damaged the part.

3. Clean the electrodes as dust adhering to these parts may prevent a good ignition. (Figure No. 7)

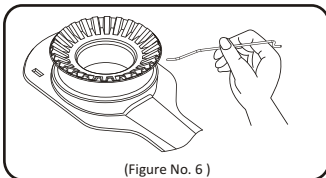

(Figure No. 6)

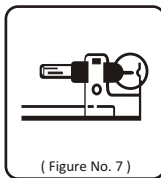

(Figure No. 7)

ATTENTION

1. Keep away any flammable material / liquid from the gas cooker.
2. The gas cooker shall be placed in a good ventilated room.
3. Never use one single rubber hose for two gas cooker.
4. Do not place any objects that may easily be blown away by the wind on the gas cooker.
5. In the event of gas leak, do not switch on any fan / lighter.
6. Do not use any small cooking utensil that may cover the burner flame and thereby extinguishing it.
7. Do not use any large cooking covering the entire gas cooker surface.
8. Replace any damage / cracked rubber hose immediately.
9. Don't touch the gas cooker immediately after cooking.
10. Take care that no boiling water spills onto the gas burner's top surface.
11. Don't use the gas cooker to dry.
12. Don't leave the gas cooker unattended when on.
13. Don't route the rubber hose under the gas cooker.

TROUBLE SHOOTING GUIDE

TROUBLE	CAUSE	SOLUTION
Flame does not ignite	Main Gas Stopcock is not turned on.	Turn off the gas cooker once and then turn it in fully.
	Air remains in the gas piping.	Repeat ignition operation until all air in the piping is purged out completely.
	Bend or crushed rubber tubing.	Straighten it, or replace it.
	Piezo electrode or insular is dirty.	Clean it with dry cloth.
Smell of gas	The gas cooker out of order.	Request to AFTER SALES SERVICE for repair.
	Cracks or holes in the rubber tubing.	Replace it with a new one.
	Rubber tubing is not connected properly.	Connect the rubber tubing properly.
	Regulator leakage.	Replace it with a new one.
Flame abnormal	The gas cooker out of order.	Request to AFTER SALES SERVICE for repair.
	Air supply is not properly adjusted.	Adjust is properly. (See Page 2 Fig. 5)
	Burner is not fitted properly.	Fix burner body properly.
	Flame outlet of burner is clogged.	Clean the clogged part.
	The gas cooker out of order.	Request to AFTER SALES SERVICE for repair.

If trouble occurs, fix it referring to the above table. But if the problem still remain, or in case a serious malfunction, and if you are doubt, then take the gas cooker to our **AFTER SALES SERVICE** for repairing without trying to repair it your self.

