



INDEX

Components & Features 2

Product installation 3

Part assembling 4

How to use 5

Exterior specifications 7

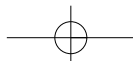
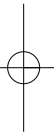
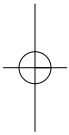



Components & Features

Components

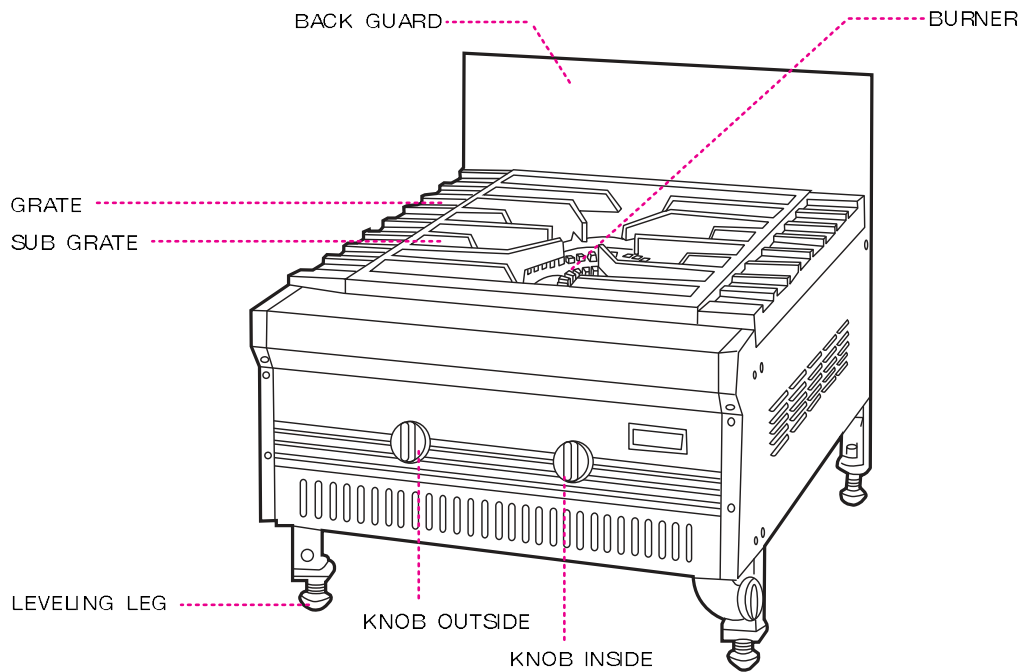

Features

1. AUTOMATIC IGNITION
2. SAFETY EXTINGUISHMENT
3. STAINLESS STEEL PLATE
4. DOUBLE BURNER ABLE TO SELECT INSIDE AND OUTSIDE
5. CORROSION-PROOF OUTSTANDING WITH THE DACRON COATING



Prior to use

■ Check Gas

-Must use the designated gas

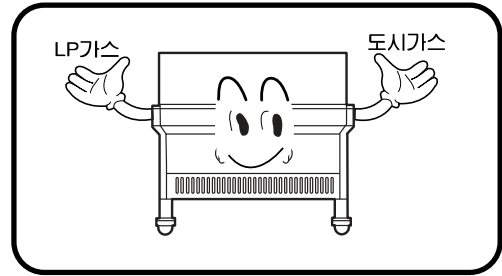

■ The knob position is "off"

-Check the knob position before opening the gas valve

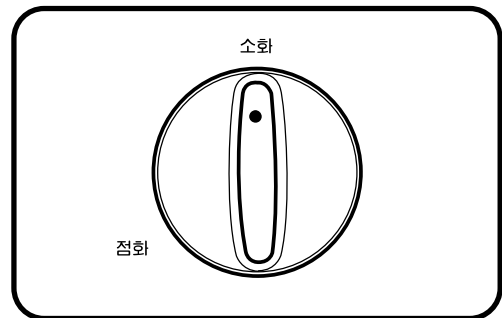

■ Gas smell

-As fuel gas contains mercaptan, a gas leakage can be detected by its odor



Product installation

■ Easy ventilate place

- During operation, make sure that both the air supply and gas exhaust system are working well

■ Flammable materials

- Never put flammables such as petroleum near the unit, which may cause a fire

■ Location of the product installation

- Please install the unit on the place in stability and even ground

■ Recommend short piping

- We recommend you to install the gas pipe shortly

■ Gas connection

- Request a gas agency or its relevant company for gas connection

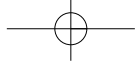

Part assembling

1. Assembly the back guard using bolts with body
2. If you not use back guard, Please install the units away 30cm from the wall

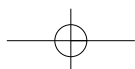
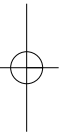
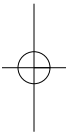
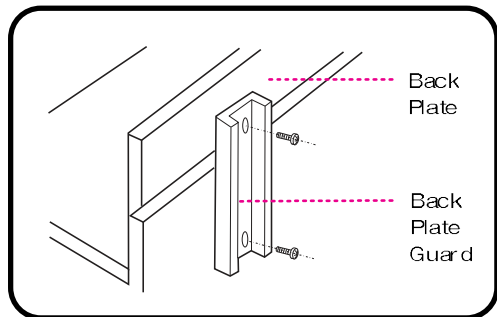



How to use

■ Open the valve

- Open the gas container valve and intermediate valve and intermediate valve

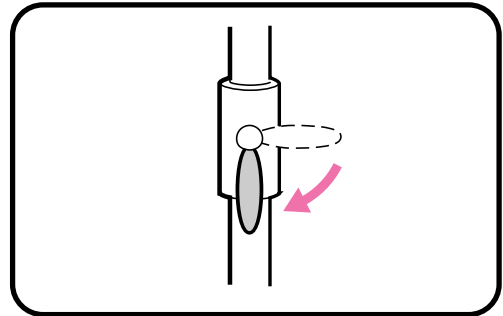

■ Ignition

- Push the knob and turn to "ON" position till the sound occur
- In case if lightening failure, quickly turn the knob to "OFF" position and repeat ignition

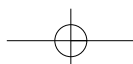
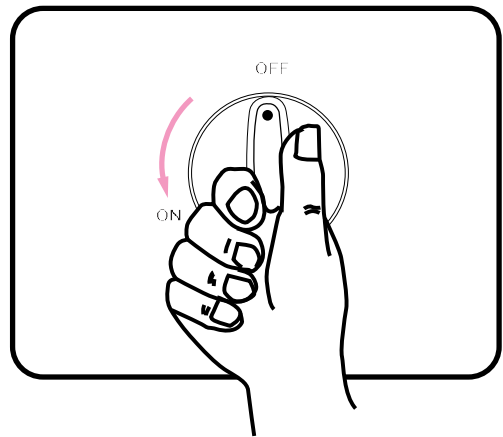



How to use

■ Flame control

- Please control the knob slowly

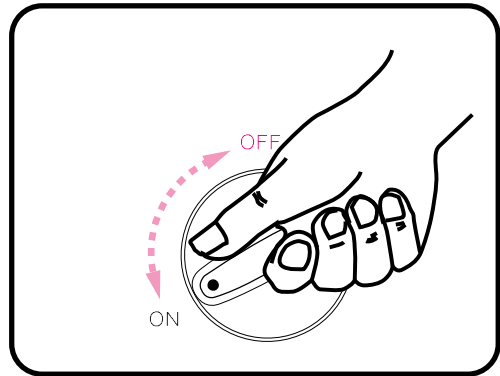

■ Extinguishment

- Turn the knob to the "off" position completely.

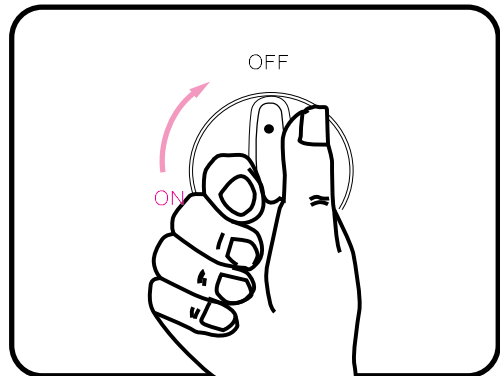

■ Close the intermediate valve

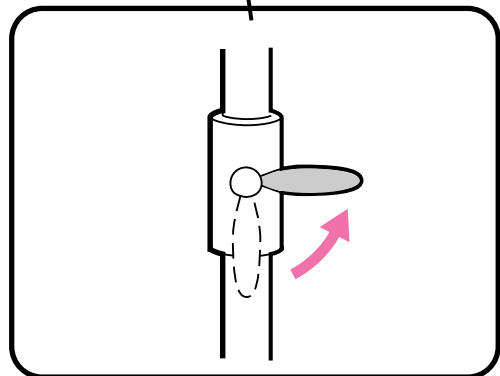



Exterior specifications

<RLT-60>

(Unit:mm)

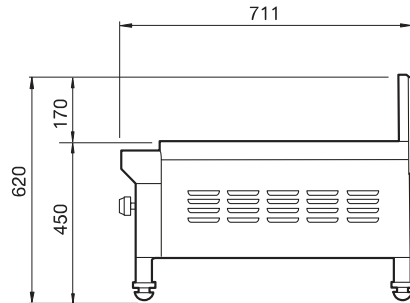
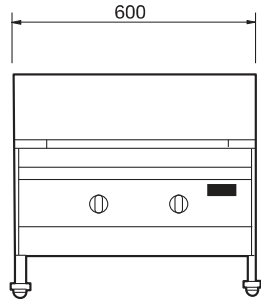

<RLT-120>

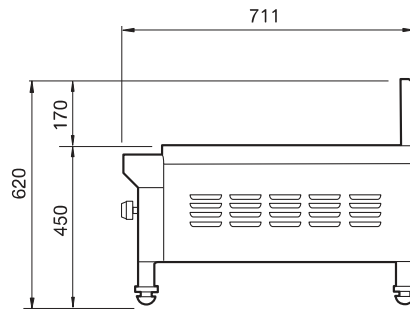
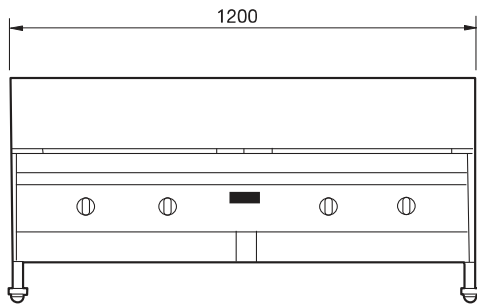

Description		Gas Range	
Mode		RLT-60	RLT-120
Size	Width	900	1200
	Length	711	711
	Height	620	620
Weight		50 kg	94kg
Gas connection		1 1/4"	
LP Gas		1.66Kg/h	3.32Kg/h

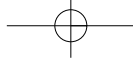

MEMO

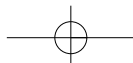
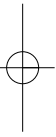

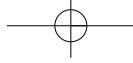

MEMO

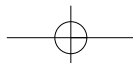
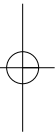

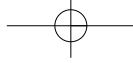

MEMO

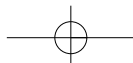
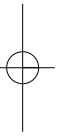

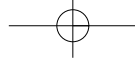

©
R

Rinnai



ver.060314

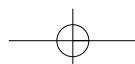



Rinnai
For the Generations to Come

U / S / E / R / G / U / I / D / E / B / I / O / O / K

Commercial Low Range **RLT-60 / RLT-120**

