

Rinnai

CONTINUOUS FLOW HOT WATER



Rinnai
∞ INFINITY

THE RINNAI INFINITY STORY

SO FAR...

In the early 2004's Rinnai launched the first fully electronic gas continuous flow hot water system in Malaysia. Appropriately named the Rinnai INFINITY because it never ran out of hot water, it not only revolutionised the market, but also domestic hot water as we then knew it!

Rinnai is proud to still be the No. 1 choice of continuous flow hot water systems for Malaysia families. Today, our products are even more sophisticated – designed with the environment in mind with our low emission burners and high efficiencies. The Rinnai INFINITY continues to provide endless hot water and when combined with Water Controllers, offers a host of safety benefits and convenience features.

The Rinnai INFINITY continuous flow hot water systems represent Rinnai's commitment to delivering the best systems available in the world today.

CONTENTS.

P4	INFINITY 26
P4	SMARTSTART®
P5	ENVIROSMART
P6	WATER CONTROLLERS
P7	RECESS BOXES
P7	ACCESSORIES

HOW TO SELECT THE BEST SYSTEM?

There are 4 important considerations to ensure that you have the correct Rinnai INFINITY to best suit your needs:

step one how many bathrooms?

The Rinnai INFINITY will never run out of hot water, but the total number of showers potentially operating at the same time is extremely important. A single bathroom home with only one shower will comfortably operate using the smaller INFINITY 16, whereas a two or three bathroom home will require the larger INFINITY 26.

step two what type of shower rose is installed?

The type of shower rose installed in your home is also important. A single 9 litre/min shower rose will comfortably operate using the smaller INFINITY 16 in conjunction with a tap being used at the same time. Many older homes however, still have higher flow rated shower roses, some as much as double the new regulations. These homes will require the larger INFINITY 26.

step three do you have a large bath or spa?

If you have a large bath or spa that needs filling, then regardless of the number of bathrooms or showers, we'd recommend the larger 26 litre INFINITY which will fill quickly.

step four the distance to bathrooms and other 'wet areas'?

The further away the shower, the longer it takes to get the hot water, and the more potential for water to be wasted down the drain. Where feasible, always install your hot water system as close as possible to the outlets that are mainly used (i.e. shower or kitchen sink). The Rinnai INFINITY is a compact unit enabling it to be installed virtually on any outside wall. If you are building or renovating, this is a great time to correct the position if it is currently too far away and water wastage is occurring. To help overcome this, Rinnai have the Smartstart® water saver accessory that has been specifically developed to help reduce water wastage (see page 4).



It is exactly that... a continuous flow hot water system that will never run out. Unlike storage tanks that might operate at mains pressure but can run out, continuous flow units deliver a pre-determined flow rate each minute for as long as the unit is running. As an example, the Rinnai INFINITY 26 is electronically controlled to deliver 26 litres of hot water per minute at a temperature rise of 25°C. This is perfect for (say) two 3 Star AAA rated (9 l/min) showers operating at once, or perhaps one shower and another tap or washing machine. Add to this the convenience of fingertip temperature control with the installation of Water Controllers, and you have the most technologically advanced hot water system available today!



All Rinnai INFINITY Hot Water Systems now incorporate our unique Rapidstart® technology. This technology enables the INFINITY to provide hot water to the outlet faster than other continuous flow models. Rapidstart® operates by speeding up the ignition process of the water heater, and through water flow adaptive technology, adjusts the flow to enable this improvement in the 'heat up' time, ultimately delivering hot water faster.



INFINITELY SUPERIOR



INFINITY 26Plus
with Pipe Cover (sold separately)



INFINITY 26
with Smartstart® (sold separately)

LEADING THE WAY.

When your installation calls for the most stylish finish as well as all round performance, consider the new Rinnai INFINITY 26.

- Modern and stylish new slimline casing
- Exciting new Star Metallic finish
- New variable hot water delivery capacity of 26 litres/min at a 25°C rise up

NEW 'STATUS MONITOR'.

Incorporated in the INFINITY 26 only is a new status monitor on the front casing. The Status Monitor can assist:



- In determining if an interruptions to hot water relates to either water or gas supply or the actual unit
- What temperature it is operating at and how many controllers are installed

HELP SAVE OUR PRECIOUS RESOURCE.

The Rinnai Smartstart® water saver has been developed to specifically reduce water wastage whenever a hot tap is turned on.

- Allows you to pre-heat the water in the pipes before you turn on the hot tap.
- Simply activated by the 'preheat' button on the Water Controller.
- Takes a minute or two to warm up depending on the size of your home.
- Saves literally tens of thousands of litres of water over the life of your hot water system.
- Plumbing is designed as a 'ring-main' or loop around the house. In existing homes, a return line can be plumbed in from the furthest point back to the INFINITY.

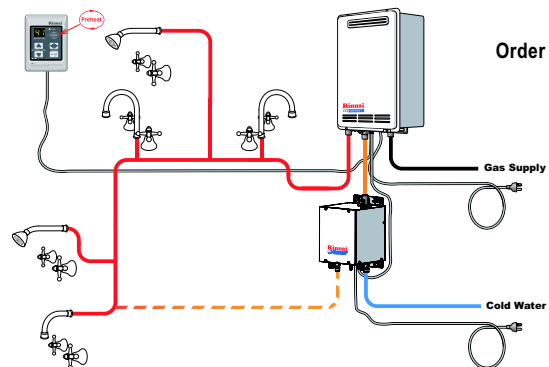

Order Code: SMARTSTART

MALAYSIA'S FIRST ENVIROSMART HOT WATER SYSTEM



ENVIROSMART, THE NO.1 CHOICE FOR ENVIRONMENTALLY FRIENDLY HOT WATER

- Australia's first hot water system that carries a 6 star energy rating
- 36% more energy efficient than a 3 star gas storage tank[#]
- 1/6 of the greenhouse gas emissions of an electric storage tank[#]
- Substantially reduced running costs
- Provides great water flow even with water saving fixtures (WELS)
- Space saving compact design
- Superior safety and precise temperature control with the use of water controllers



HELP SAVE THE ENVIRONMENT

Switching from an electric storage tank to a Rinnai EnviroSmart reduces greenhouse gas emissions by an average of 3.6 tonnes per annum. **This is equivalent of taking around one and a half small cars off the road[#].**

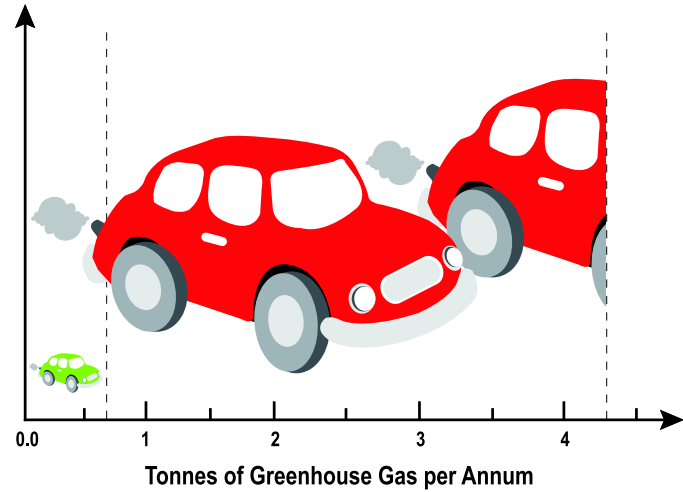

■ EnviroSmart 0.67 Tonnes ■ Electric Storage Tank 4.3 Tonnes

SAVE MONEY

This graph shows the cumulative running cost of EnviroSmart compared to an electric storage tank, over a period of 12 years.

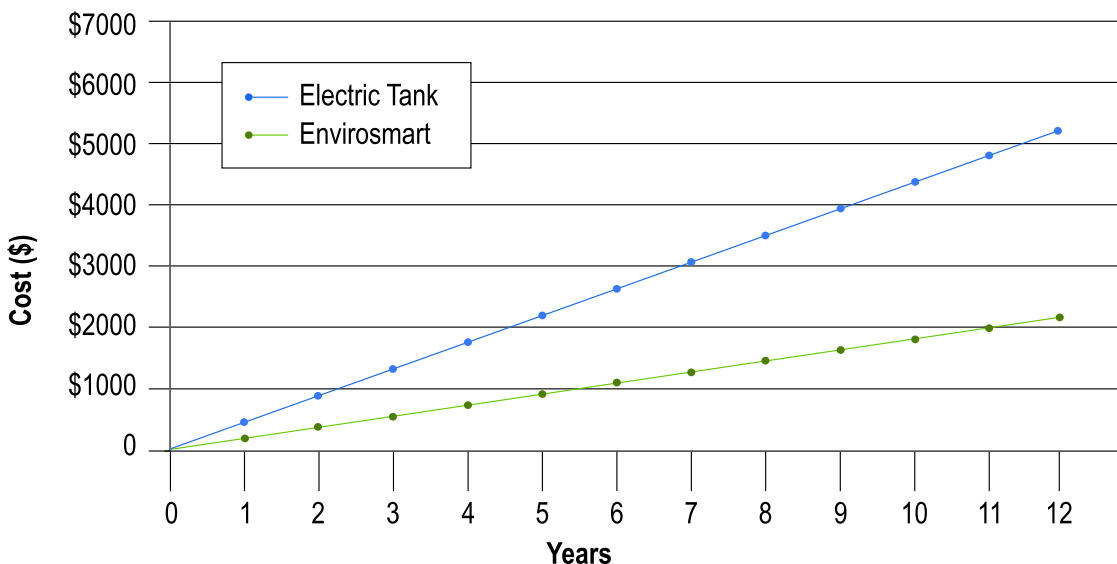

Running costs calculated using Victorian gas and electricity tariffs at June 2007[#]



INFINITELY SAFER



Deluxe Bathroom Controller

Deluxe Master Controller

Water Controller	Width	Height	Colour	Order Code
Universal	90 mm	120 mm	Grey	MC91Q2A
Deluxe Master	128 mm	120 mm	White	MC100V1W
			Silver	MC100V1S
Deluxe Bathroom	202 mm	104 mm	White	BC100V1W
			Silver	BC100V1S

DELUXE WATER CONTROLLERS.

Our Deluxe Water Controllers provide all the benefits of the Universal Controller, plus allow you to achieve ultimate control with a few fantastic additional features.

These Water Controllers comprise of a Master Controller (usually installed in the kitchen) and separate Bathroom Controllers complete with clock, speaker and volume controls. In addition, the Deluxe Bathroom Controllers include:

'Bath fill' function

This feature allows you to automatically fill a bath to the desired level and at the precise temperature you want, at the touch of a button. The INFINITY will automatically turn off the hot water flow and a voice recording will advise you when the bath is full. Select (say) 30 litres for young kids, 60 litres for older kids and anything up to 400 litres for baths and spas.

'Shower Saver' function

This feature allows you to program a desired temperature and exactly how much water you wish to use for showering. Eg. if you have a 3 Star (AAA) rated shower rose and you select the 30 litre level on your water controller then your shower will automatically shut off in approximately 3 minutes.

PLEASE NOTE: Water Controllers are sold separately.

WHAT HAPPENS WITH NO WATER CONTROLLERS?

The Rinnai INFINITY units operate efficiently without the installation of Water Controllers as well. In these installations you will be required to mix the hot water with the cold water tap, the same as a conventional storage tank system. In some instances, a slight temperature fluctuation may be experienced if someone turns on another tap or flushes the toilet, just like other hot water systems. These temperature fluctuations are eliminated with the installation of Controllers as the temperature is pre-set by you and no cold water is added.

WHY WATER CONTROLLERS ARE SO IMPORTANT.

We strongly recommend installing Water Controllers to allow you to take full advantage of all the benefits available:

- | | |
|-------------|--|
| SAFETY | <ul style="list-style-type: none"> Precise temperature control reduces the chance of scalding, particularly for children. Enables you to bath the baby at (say) 38°C, the kids at 40°C and yourself at 42°C. |
| COMFORT | <ul style="list-style-type: none"> Controllers eliminates temperature fluctuations should someone else turn on another tap. Simply select your desired temperature and turn on the hot tap... never use the cold tap again! |
| PERFORMANCE | <ul style="list-style-type: none"> Eliminate water wastage that occurs adjusting the hot and cold taps. Water Controllers will prolong the life of your INFINITY and we back this with an extended warranty for installation of 2 or more Water Controllers. Water Controllers are essential for the operation of our Smartstart® pre-heat water saving system. |

UNIVERSAL WATER CONTROLLER.

In Use Light

Illuminates to show that the hot water is running somewhere in the home.

Temperature Display

Allows you to keep an eye on the temperature wherever Controllers are installed.

Temperature Control

Precise control - Up and Down.



Preheat Button

This is used when the INFINITY is installed with the Smartstart® pre-heat water saving system.

Transfer Button & Light

Inbuilt safety - when activated in one room, the temperature cannot be accidentally changed elsewhere once the hot water is on.

On/Off Button

Electronically shuts off the hot water. Great for stopping long teenage showers!

PLEASE NOTE: Water Controllers are sold separately.

VIRTUALLY HIDE YOUR HOT WATER SYSTEM.

When installing a Rinnai INFINITY in a new home or renovation, you should consider including the innovative Smartbox® at the construction stage. These boxes allow you to virtually hide the hot water system into the cavity enabling a smooth and neat finish to the job.

- Ideal for new homes or major renovations
- Save precious space by utilising the existing wall cavity
- Made from durable light weight ABS plastic
- Suits any application:
 - Brick – compatible for use with brick ties
 - Rendered – complete with off-set spacers
 - Weatherboard – used with semi-recess frame*
- Full or semi recess options available
- Supplied standard in neutral DUNE colour – UV stabilised
- Fully paintable to blend with any colour scheme

Suits	Material	Opening Dimensions (mm)			Wall Protrusion (mm)	Recess	Order Code
		Width	Height	Depth			
INFINITY 16 & 26	ABS Plastic	385 - 395	1025 - 1050	160	55	Full	SBOX
				95	125	Semi	SBOXF*

*ordered in addition to the full Recess Box (SBOXF available November 2006).



Wall Cavity Recess Box

PIPE COVERS.

Pipe Covers can be easily attached to all Rinnai INFINITY Hot Water units to:





- Cover the pipes, valves and even the external power point
- Provides a clean and smooth finish to the installation.
- Two pipe covers can even be joined together to hide longer pipe work under the unit if required.

Suits	Width	Height	Depth	Colour	Order Code
INFINITY 16 & 26	350 mm	400 mm	160 mm	Euro White	PC11



Pipe Cover

INFINITY V-SERIES HOT WATER SPECIFICATIONS.

Indicative usage examples The number of bathrooms the INFINITY can supply is dependent on water pressure, ambient water temperature and the outlets' water flow capacity.	2 - 3 bathroom homes	4 - 5 bathroom homes	4 - 5 bathroom homes	4 - 5 bathroom homes
	 External	 External	 Internal	 External
Hot Water Capacity raised at 25°C* (Unmixed Flow Rate)	16 L/min (960 L/hr)	26 L/min (1560 L/hr)	26 L/min (1560 L/hr)	24 L/min (1440 L/hr)
Hot Water Capacity raised at 20°C* (Unmixed Flow Rate)	20 L/min (1200 L/hr)	26 L/min (1560 L/hr)	32 L/min (1920 L/hr)	30 L/min (1800 L/hr)
Height x Width x Depth (mm)	530 x 350 x 194	530 x 350 x 194	600 x 350 x 234 - 275	600 x 350 x 277
Weight	15 kg	15 kg	21 kg	28 kg
Gas Input: Low	18 MJ/h	23 MJ/h	16 MJ/h	15.9 MJ/h
Gas Input: High	125 MJ/h	199 MJ/h	195 MJ/h	162 MJ/h
Water Operating Pressure (kPa)**	120 - 1000	200 - 1000	140 - 1000	140 - 1000
Water Temperature Range (factory pre-set)	13 steps from 37°C up to 55°C*** with Water Controllers			
Colour	Euro White			
Heat Exchanger Warranty	10 years			12 years
Parts & Labour Warranty	2 Years			
Minimum Flow L/min	2.4			
Ignition	Direct electronic ignition with automatic flame sensing			
Gas Type	LPG			
Electrical Supply	AC 240V 50 Hz (10 amp weatherproof power point required within 500 mm of the unit)			
Water Controllers	Up to 4 Water Controllers can be installed			

- * The number after the INFINITY refers to the maximum litres of hot water raised at 25°C per minute, i.e. INFINITY 26 is a 26 litre unit. Continuous flow models are not mains pressure and a difference in pressure might be noticed if you are upgrading from a storage tank.
- ** These units can be factory pre-set to deliver a maximum temperature of 50°C. Check local authorities as to whether a tempering valve is also required.
- *** All Rinnai INFINITY models will operate at lower pressures, however the specified flow rates may not be achieved. Gas pipe sizing should be performed using an approved sizing chart, as specified in AS 5601 / AG 601. Water pipe sizing should be in accordance with AS 3500.

Please note: Installation of domestic INFINITY products in commercial applications will reduce the warranty. Rinnai (M) reserves the right to make modifications and change specifications without notice.

Phone 03-5191 9541 for a free brochure on the products listed below.

- Commercial Hot Water
- Solar Hot Water
- Gas Heater Pump

Rinnai

RINNAI (M) SDN BHD

Lot 2-36 & 2-38, Jalan SU 7, Seksyen 26, Persiaran Tengku Ampuan,
40400 Shah Alam, Selangor Darul Ehsan.

Tel : 03 - 5191 9541 / 5191 7752 Fax : 03 - 5192 4011

email: infinity@rinnai.com.my URL <http://www.rinnai.com.my>